



Master Assortment No. 020-630

OIL DRAIN PLUGS BOUCHONS DE VIDANGE

DRAIN and FILLER PLUGS BOUCHONS DE VIDANGE

'Papco' Drain Plugs are manufactured in nine types and are available in Inch and Metric sizes. Type 2 oversize plugs are tapered, hardened and cut their own thread where the original has been stripped. To use an oversize plug, hold in a straight position and tighten with a socket wrench. Plug is then removed to clear metal particles and then reinstalled. Each Drain Plug is supplied with a gasket, as indicated in the gasket chart, with an asterisk (*).

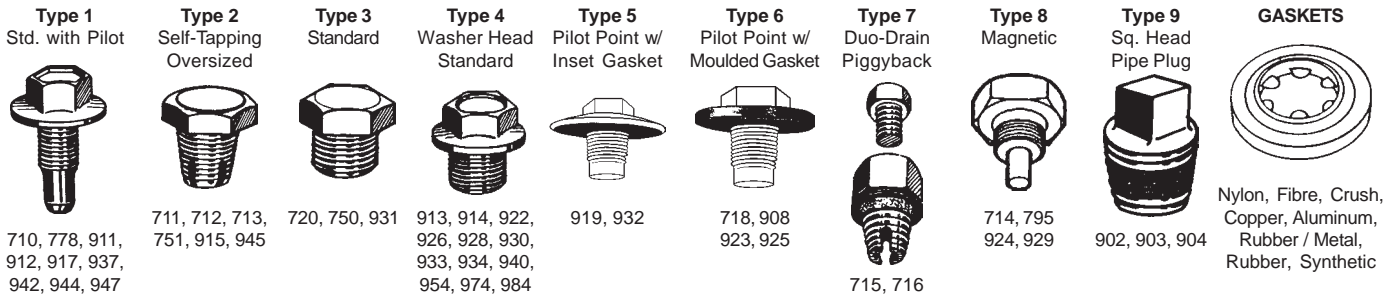

710, 778, 911, 912, 917, 937, 942, 944, 947

711, 712, 713, 751, 915, 945

720, 750, 931

913, 914, 922, 926, 928, 930, 933, 934, 940, 954, 974, 984

919, 932

718, 908, 923, 925

715, 716

714, 795, 924, 929

902, 903, 904

Nylon, Fibre, Crush, Copper, Aluminum, Rubber / Metal, Rubber, Synthetic

DRAIN PLUGS				GASKETS							
Stock No.	Size & Thread	Type	Std. Pkg.	Nylon	Fibre	Copper	Crush	Aluminum	Rubber /Metal	Rubber	Synthetic
263-710	1/2-20 Std.	1	5	263-816*	263-800	263-856		263-869	263-875		263-885
263-711	1/2-20 S.O. Self-Tap	2	12	263-816*	263-801	263-856	263-844		263-875		
263-712	1/2-20 D.O. Self-Tap	2	12	263-817*	263-801	263-857		263-870			
263-713	1/2-20 T.O. Self-Tap	2	12	263-817*	263-802	263-860					
263-714	1/2-20 Magnetic	8	5	263-816*	263-800	263-856			263-875		
263-715	1/2-20 D.O. Duo-Drain	7	5	263-817*	263-801	263-857		263-870			
263-716	1/2-20 Std. Duo-Drain	7	5	263-816*	263-800	263-856			263-875		
263-718	1/2-20 Pilot Pt. w/ Molded Gasket	6	5	N/R	N/R	N/R	N/R	N/R	N/R	N/R	N/R
263-720	5/8-18 Std.	3	5	263-820*		263-857					
263-750	3/4-16 Std.	3	5	260-824*	263-804		263-851				
263-751	3/4-16 S.O. Self-Tap	2	5	263-824*	263-805		263-851				
263-778	1/2-20 Std.	1	5	263-816	263-800	263-856		263-869	263-875*		263-885
263-795	1/2-20 Magnetic	8	5	263-816	263-800	263-856		263-869	263-875*		263-885
263-908	M12 x 1.75 Pilot Pt. w/ Moulded Gasket	6	5	N/R	N/R	N/R	N/R	N/R	N/R	N/R	N/R
263-911	M12 x 1.75 Std. with Pilot Pt.	1	5	263-815*	263-808	263-855		263-869	263-875	263-874	
263-912	M12 x 1.25 Std. with Pilot Pt.	1	5	263-815*	263-808	263-855		263-869	263-875	263-874	
263-913	M12 x 1.25 Std.	4	5	263-815*	263-808	263-855		263-869	263-875	263-874	
263-914	M14 x 1.5 Std.	4	5	263-817*	263-801	263-856	263-844	263-870	263-876		
263-915	M14 x 1.5 S.O. Self-Tap	2	5	263-820*		263-860					
263-917	M14 x 1.5 Std. with Pilot	1	5	263-817*	263-801	263-856	263-844	263-870	263-876		
263-919	M12 x 1.75 Pilot Pt. w/Inset Gasket	5	5	N/R	N/R	N/R	N/R	N/R	N/R	N/R	N/R
263-922	M14 x 1.25 Std.	4	5	263-817*	263-801	263-856	263-844	263-870	263-876		
263-923	M14 x 1.5 Pilot Pt. w/ Molded Gasket	6	5	N/R	N/R	N/R	N/R	N/R	N/R	N/R	N/R
263-924	M14 x 1.5 Magnetic	8	5	263-817*	263-801	263-856	263-844	263-870	263-876		
263-925	M14 x 1.5 Pilot Pt. w/ Molded Gasket	6	5	N/R	N/R	N/R	N/R	N/R	N/R	N/R	N/R
263-926	M16 x 1.33	4	5	263-820	263-809*						
263-928	M18 x 1.5 Std.	4	5	263-824	263-810*			263-873			
263-929	M12 x 1.75 Magnetic w/PP & Gasket	8	5	N/R	N/R	N/R	N/R	N/R	N/R	N/R	N/R
263-930	M20 x 1.5 Std.	4	5	263-824	263-807		263-851*				
263-931	M12 x 1.5 Std.	3	5	263-815	263-808	263-855		263-869*	263-875	263-874	
263-932	M12 x 1.75 Pilot Pt. w/ Inset Gasket	5	5	N/R	N/R	N/R	N/R	N/R	N/R	N/R	N/R
263-933	M12 x 1.25 Std.	4	5	263-815	263-808	263-855		263-869	263-875	263-874	263-885*
263-934	M14 x 1.5 Std.	4	5	263-817	263-801	263-856	263-844	263-870*	263-876		
263-937	M14 x 1.5 Pilot Pt.	1	5	263-817	263-801	263-856	263-844	263-870	263-876*		
263-940	M22 x 1.5 Std.	4	5	263-828*							
263-942	M12 x 1.25 Pilot Pt.	1	5	263-815	263-808	263-855		263-869*	263-875	263-874	263-885
263-944	M12 x 1.75 Pilot Pt.	1	5	263-815	263-808	263-855		263-870	263-875*	263-874	
263-945	M12 x 1.75 S.O. Self-Tap	2	5	263-817	263-801	263-855	263-844	263-870	263-876*		
263-947	M14 x 1.5 Pilot Pt.	1	5	263-817	263-801	263-856*	263-844	263-870	263-876		
263-954	M14 x 1.5 Std.	4	5	263-817	263-801	263-856*	263-844	263-870	263-876		
263-958	M14 x 1.5 Pilot Pt. w/ Inset Gasket	5	5	N/R	N/R	N/R	N/R	N/R	N/R	N/R	N/R
263-974	M14 x 1.5 Std.	4	5	263-817	263-801	263-856	263-844*	263-870	263-876		
263-984	M14 x 1.5 Std.	4	5	263-817	263-801	263-856	263-844	263-870	263-876*		
263-990†	UNIV. 1/2-3/4, 12-18mm	-	3	N/R	† N/R	N/R	N/R	N/R	N/R	N/R	N/R
260-902	1/4" Sq. Pipe Plug	9	12	* - Indicates type of gasket supplied with plug. ALL GASKETS STANDARD PACKAGE 25 PIECES							
260-903	3/8" Sq. Pipe Plug	9	12								
260-904	1/2" Sq. Pipe Plug	9	12								

† - See page 3 for full description.

263
Series



DRAIN PLUG GASKETS JOINTS POUR BOUCHON DE VIDNAGE

'Papco' Selon® Drain Plug Gaskets are made of special nylon with excellent mechanical properties and long life. Also available are copper and fibre gaskets as well as aluminum, rubber/metal and synthetic gaskets.

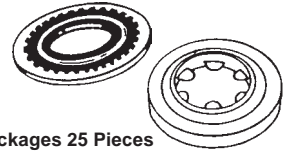

Order by Stock Number

Standard Packages 25 Pieces

Part No.	I.D. x O.D. x Thick	Part No.	I.D. x O.D. x Thick	Part No.	I.D. x O.D. x Thick
263-800	Fibre 1/2 x 3/4 x 3/32	263-816	Nylon 9/16 x 13/16 x .052	263-860	Copper 3/4 x 1-1/16 x .062
263-801	Fibre 9/16 x 13/16 x 3/32	263-817	Nylon 5/8 x 15/16 x .059	263-869	Alum. 15/32 x 7/8 x .080
263-802	Fibre 5/8 x 7/8 x 3/32	263-820	Nylon 11/16 x 1 x .062	263-870	Alum. 14mm x 20mm x .078
263-804	Fibre 3/4 x 1-1/16 x 3/32	263-824	Nylon 13/16 x 1-1/16 x .082	263-873	Alum. 18mm x 26mm x .078
263-805	Fibre 13/16 x 1 x 3/32	263-828	Nylon 31/64 x 1-1/4 x .078	263-874	Rubber 12mm x 20mm x .102
263-807	Fibre .920 x 1-1/8 x 3/32	263-844	Crush 17/32 x 3/4 x .080	263-875	Rubber/Met.12mm x 25mm x .078
263-808	Fibre 12mm x .748 x 3/32	263-851	Crush 25/32 x 1 x .087	263-876	Rubber/Met.17/32 x 31/32 x .081
263-809	Fibre 16mm x 1.062 x 3/32	263-855	Copper 31/64 x 3/4 x .094	263-885	Synthetic 15/32 x 15/16 x .078
263-810	Fibre 18mm x 1.062 x 3/32	263-856	Copper 19/32 x 13/16 x .062		
263-815	Nylon 31/64 x 3/4 x .052	263-857	Copper 5/8 x 1 x .062		



OIL DRAIN PLUG REPAIR RÉPARATION DE BOUCHON DE VIDANGE

Exclusively patented winged drain plug is used when the oil pan or flange is broken or missing.

Eliminating the need to replace the pan.

Part number 263-990 is a time and money saver for pans with 1/2" to 3/4" or 12mm to 18mm drain holes. Requires no tools to install.

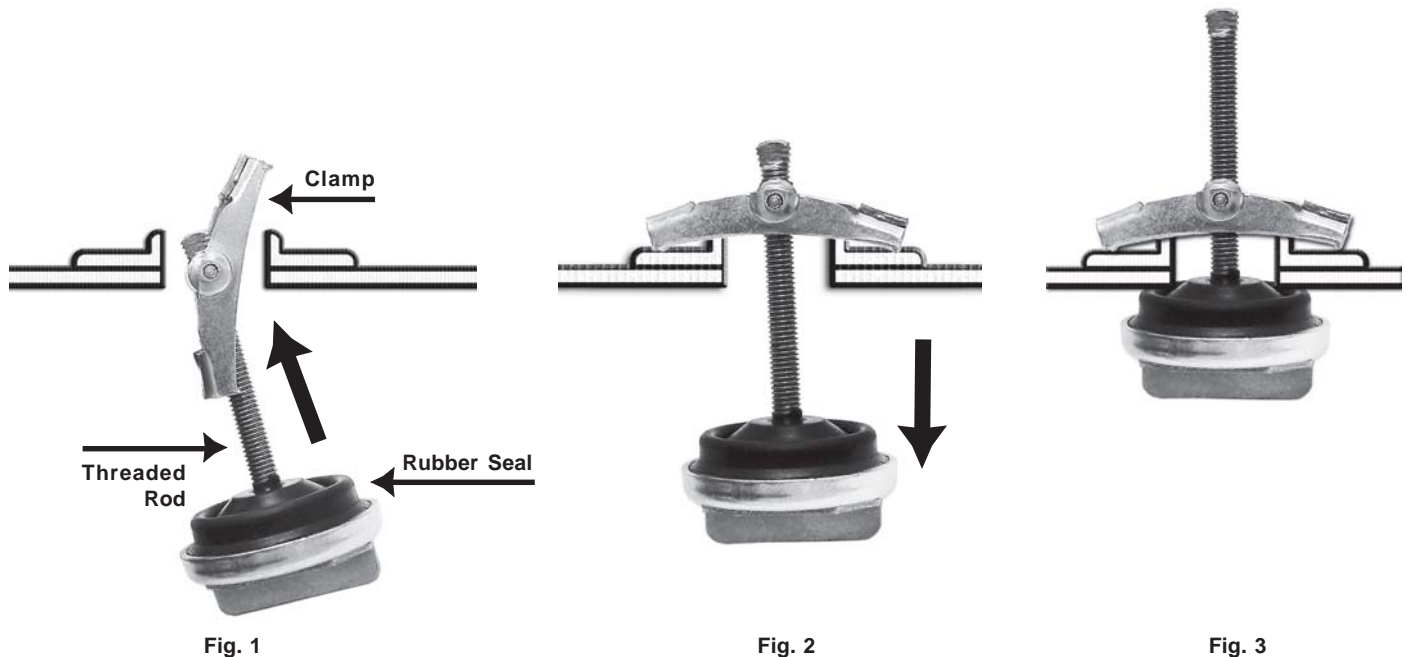

CAUTION: DO NOT use on Honda or Volkswagen. Make sure threaded bolt will not contact any internal parts before installation. Bolt enters oil pan 1-7/8".

CAUTION: This type of plug is designed to be **HAND TIGHTENED ONLY**.

DRAIN PLUG APPLICATION CHART

APPLICATION DE BOUCHON DE VIDANGE

Make/ Engine/Years	Size	Drain Plug Stock #	Gasket Stock #	Make/ Engine/Years	Size	Drain Plug Stock #	Gasket Stock #
ACURA				CADILLAC			
4, 5 & 6 Cyl. – All				4 Cyl. – All			
2003-`86	M14 x 1.5	263-934	263-870	1988-`87	M12 x 1.75 – Cimarron	263-944	263-875
AMERICAN MOTORS				1986-`82 1/2-20 263-778 263-875			
4 Cyl. – 2.5L (150)				6 Cyl. – All			
1984-`83	M14 x 1.25	263-922	263-817	1988-`80	1/2-20 – Gas Engines	263-778	263-875
4 Cyl. – 2.5L (151)				8 Cyl. – 4.1L (250); 4.5L (273)			
1983-`80	M12 x 1.75	263-911	263-815	1992-`87	M12 x 1.75 – Allante	263-944	263-875
6 Cyl. – 4.2L (258)				1990-`85 M12 x 1.75 – 263-919 N/R			
1988-`71	1/2-20	263-778	263-875	Inc: `85 Deville/Fleetwood FWD			
AUDI				1985-`82 M12 x 1.75 – Eldorado / 263-944 263-875			
4, 5 & 6 Cyl. – All				Seville/ Fleetwood / Brougham			
1994-`78	M14 x 1.5	263-947	263-856	8 Cyl. – 4.6L (279); 4.9L (300)`95-`91			
BMW				2004-`97 M12 x 1.75 – Magnetic 263-929 N/R			
4, 6, 8 & 12 Cyl. – All				1996-`91 M12 x 1.75 – Non-Magnetic 263-919 N/R			
2001-`68	M12 x 1.5	263-931	263-869	8 Cyl. – 5.0L (305); 5.0L (307)`90-`86			
BUICK				1992-`86 1/2-20 – VIN Y 263-778 263-875			
4 Cyl. – 1.8L (112)				8 Cyl. – 5.3L (323)`04-`02; 5.7L (350); 6.0L (364)`04-`02			
1986-`83	M14 x 1.5	263-934	263-870	2004-`99	M12 x 1.75 – 263-929 N/R		
1982	1/2-20 – VIN G	263-778	263-875	Inc: `00-`99 Escalade Magnetic			
4 Cyl. – 2.0L (122)				1996-`76 1/2-20 – Non-Magnetic 263-778 263-875			
1989-`87	M12 x 1.75 – VIN 1	263-944	263-875	1996 M12 x 1.75 – Non-Magnetic 263-919 N/R			
1988-`87	M14 x 1.5 – VIN K	263-934	263-870	1993-`92 1/2-20 – Magnetic 263-795 263-875			
1986-`83	1/2-20	263-778	263-870	8 Cyl. – 6.0L (368)			
4 Cyl. – 2.2L (133)				1984-`82 M12 x 1.75 263-944 263-875			
1995-`93	M12 x 1.75	263-919	N/R	1981-`80 1/2-20 263-778 263-875			
1995-`93	M12 x 1.75	263-944	263-875	CHECKER			
4 Cyl. – 2.3L (138); 2.4L (146)				6 & 8 Cyl. – All			
1998-`97	M12 x 1.75 – Magnetic	263-929	N/R	1982-`68	1/2-20	263-710	263-816
1996-`92	M12 x 1.75 – Non-Magnetic	263-919	N/R	CHEVROLET			
1991-`88	M12 x 1.75	263-911	263-815	3 Cyl. – 1.0L (993cc); 4 Cyl. – 1.3L (1295cc)			
4 Cyl. – 2.5L (151)				2001-`98 M14 x 1.5 – Metro 263-914 263-817			
1989-`87	M12 x 1.75	263-944	263-875	4 Cyl. – 1.5L (92)			
1987-`80	M12 x 1.75 – Century / Skylark / Sommerset AT	263-944	263-875	1988-`85 M14 x 1.5 – Spectrum 263-914 263-817			
6 Cyl. – 2.8L (173)				1988-`85 M12 x 1.25 – Nova 263-942 263-869			
1986-`82	1/2-20 – Inc: `82 Skylark	263-778	263-875	1987-`76 1/2-20 – Chevette, Gas 263-710 263-816			
1982	M12 x 1.75 – Century	263-911	263-815	4 Cyl. – 1.8L (110); 1.8L (112)`82 Cavalier			
6 Cyl. – 3.0L (181)				2002-`98 M12 x 1.25 – Prizm 263-942 263-869			
1989-`85	1/2-20	263-778	263-875	1982-`81 1/2-20 – Chevette, Diesel 263-778 263-875			
1988-`82	M12 x 1.75	263-944	263-875	4 Cyl. – 1.8L (1788cc)			
6 Cyl. – 3.1L (191)				2004-`98 M12 x 1.25 – Prizm 263-942 263-869			
2004-`97	M12 x 1.75 – Magnetic	263-929	N/R	4 Cyl. – 2.0L (121)			
1996-`94	M12 x 1.75 – Non-Magnetic	263-919	N/R	1989-`87 M12 x 1.75 263-944 263-875			
1993-`89	M12 x 1.75	263-944	263-875	1986-`83 1/2-20 263-778 263-875			
6 Cyl. – 3.3L (204); 3.4L (207); 3.8L (231); 4.1L (252)				2004-`97 M12 x 1.75 – Magnetic 263-929 N/R			
2004-`97	M12 x 1.75 – Magnetic	263-929	N/R	1996-`93 M12 x 1.75 – Non-Magnetic 263-919 N/R			
1996-`95	M12 x 1.75 – Non-Magnetic	263-919	N/R	1995-`90 M12 x 1.75 263-944 263-875			
1994-`75	1/2-20	263-778	263-875	4 Cyl. – 2.3L (138)`95-`90; 2.4L (146)`03-`97			
8 Cyl. – 4.3L (265); 4.9L (301)				2004-`97 M12 x 1.75 – Magnetic 263-929 N/R			
1981-`79	M12 x 1.75	263-944	263-875	1996-`90 M12 x 1.75 – Non-Magnetic 263-919 N/R			
8 Cyl. – 4.4L (267); 5.0L (305); 5.0L (307)				4 Cyl. – 2.5L (151)			
1991-`80	1/2-20 – VIN Y	263-778	263-875	1992-`78 M12 x 1.75 263-944 263-875			
1979-`77	1/2-20 – VIN Y	263-710	263-816	6 Cyl. – 2.8L (173)			
8 Cyl. – 5.7L (350) ROADMASTER				1989-`87 M12 x 1.75 263-944 263-875			
1996-`80	1/2-20	263-778	263-875	1986-`82 1/2-20 263-778 263-875			
1996	M12 x 1.75	263-919	N/R	1981-`80 M12 x 1.75 263-944 263-875			

263
Series



DRAIN PLUG APPLICATION CHART

APPLICATION DE BOUCHON DE VIDANGE

Make/ Engine/Years	Size	Drain Plug Stock #	Gasket Stock #	Make/ Engine/Years	Size	Drain Plug Stock #	Gasket Stock #
CHEVROLET (continued)				CHEVROLET / GMC TRUCK (continued)			
6 Cyl. - 3.1L (189)				8 Cyl. - 6.0L (364) '04-'99; 6.0L (366)			
2003-'97	M12 x 1.75 - Magnetic	263-929	N/R	2004-'97	M12 x 1.75 - Magnetic	263-929	N/R
1996-'94	M12 x 1.75 - Inc: Beretta, Corsica AT - Non-Magnetic	263-919	N/R	1996-'91	M12 x 1.75 - Non-Magnetic	263-919	N/R
1995-'90	M12 x 1.75 - Exc: Beretta '95-'94; Corsica '95 AT	263-944	263-875	1996-'91	1/2-20	263-778	263-875
6 Cyl. - 3.4L (207); 3.8L (229) '84-'80; 3.8L (231); 4.3L (262) '93-'85				8 Cyl. - 6.2L (379)			
2004-'97	M12 x 1.75 - Magnetic	263-929	N/R	1993-'91	M12 x 1.75	263-919	N/R
1996-'95	M12 x 1.75 - Non-Magnetic	263-919	N/R	1993-'91	1/2-20	263-710	263-816
1994-'78	1/2-20	263-778	263-875	1990-'82	1/2-20	263-778	263-875
8 Cyl. - 4.3L (265)				8 Cyl. - 6.5L (395)			
1996-'94	1/2-20 Caprice	263-778	263-875	2002-'97	M12 x 1.75 - Magnetic	263-929	N/R
8 Cyl. - 4.4L (267) '82-'80; 5.0L (305); 5.0L (307) '90-'86				8 Cyl. - 7.0L (427)			
1993-'80	1/2-20 - VIN Y	263-778	263-875	1998-'97	M12 x 1.75 - Magnetic	263-929	N/R
8 Cyl. - 5.7L (350)				8 Cyl. - 7.4L (454); 8.1L (496) '04-'01			
2004-'97	M12 x 1.75 - Magnetic	263-929	N/R	1996-'91	M12 x 1.75 - Non-Magnetic	263-919	N/R
1996	M12 x 1.75 - Non-Magnetic	263-919	N/R	1996-'68	1/2-20 - Magnetic	263-795	263-875
1996-'80	1/2-20	263-778	263-875	8 Cyl. - 7.4L (454); 8.1L (496) '04-'01			
1995-'90	5/8-18 - Corvette	263-720	263-820	2001-'97	M12 x 1.75 - Magnetic	263-929	N/R
CHEVROLET / GMC TRUCK				1996-'95			
4 Cyl. - 1.6L (98); 1.9L (119) '85-'82; 2.0L (122)				1996-'80			
2004-'99	M14 x 1.5 - Tracker	263-934	263-870	1996-'80			
4 Cyl. - 2.2L (134); 2.5L (153) '04-'01				1996-'80			
2004-'97	M12 x 1.75 - Magnetic	263-929	N/R	1996-'80			
1996-'95	M12 x 1.75 - Non-Magnetic	263-944	263-875	1996-'80			
1994	1/2-20	263-778	263-875	1996-'80			
4 Cyl. - 2.5L (151)				1996-'80			
1993-'91	1/2-20	263-778	263-875	1996-'80			
1990-'85	M12 x 1.75	263-944	263-875	1996-'80			
4 Cyl. - 3.9L (239)				1996-'80			
1991-'89	1/2-20 - P30; Diesel	263-778	263-875	1996-'80			
6 Cyl. - 2.8L (173); 4.1L (250) '84-'80				1996-'80			
1990-'87	M12 x 1.75	263-944	263-875	1996-'80			
1986-'82	1/2-20	263-778	263-875	1996-'80			
6 Cyl. - 3.4L (207)				1996-'80			
2004-'97	M12 x 1.75 - Magnetic	263-929	N/R	1996-'80			
6 Cyl. - 4.2L (256) '04-'02; 4.3L (262); 4.9L (292) '90-'80				1996-'80			
2004-'97	M12 x 1.75 - Magnetic	263-929	N/R	1996-'80			
1996-'95	M12 x 1.75 - Non-Magnetic Inc: '95, 2 nd design	263-919	N/R	1996-'80			
1995-'80	1/2-20	263-778	263-875	1996-'80			
1994-'91	1/2-20 - 'S' Series Magnetic	263-795	263-875	1996-'80			
8 Cyl. - 4.8L (294) '04-'99; 5.0L (305)				1996-'80			
2004-'97	M12 x 1.75 - Magnetic	263-929	N/R	1996-'80			
1996-'95	M12 x 1.75 - Non-Magnetic Inc: '95, 2 nd design	263-919	N/R	1996-'80			
1995-'80	1/2-20	263-778	263-875	1996-'80			
8 Cyl. - 5.3L (323) '04-'99; 5.7L (350); 6.0L (364) '04-'99				1996-'80			
2004-'97	M12 x 1.75 - Magnetic	263-929	N/R	1996-'80			
1996-'95	M12 x 1.75 - Non-Magnetic	263-919	N/R	1996-'80			
1995	1/2-20 - Magnetic	263-795	263-875	1996-'80			
1995-'78	1/2-20 - Non-Magnetic	263-778	263-875	1996-'80			
1979-'78	1/2-20 - Gas Engine	263-710	263-816	1996-'80			
				CHRYSLER			
				4 Cyl. - 2.0L (122)			
				2000-'95 M14 x 1.5 263-923 N/R			
				4 Cyl. - 2.2L (135)			
				1990-'85 1/2-20 263-710 263-816			
				4 Cyl. - 2.4L (148)			
				2003-'01 M14 x 1.5 - PT.Cruiser, '03-'02 Voyager, Sebring DOHC 263-958 N/R			
				2001 M14 x 1.5 - PT.Cruiser 263-923 N/R			
				2003-'01 M14 x 1.5 - Sebring SOHC 263-974 263-844			
				2000-'96 M14 x 1.5 263-923 N/R			
				1995 1/2-20 263-718 N/R			
				4 Cyl. - 2.5L (153)			
				1993-'86 1/2-20 263-710 263-816			
				4 Cyl. - 2.6L (156)			
				1985-'83 M14 x 1.5 263-974 263-844			
				4 Cyl. - 2.6L (2555cc)			
				1989-'87 M14 x 1.5 - Conquest 263-974 263-844			
				6 Cyl. - 2.5L (152)			
				2000-'94 M14 x 1.5 263-974 263-844			
				6 Cyl. - 2.7L (167)			
				2003-'01 M14 x 1.5 263-958 N/R			
				2000-'98 M14 x 1.5 - Inc: Concord 263-923 N/R			
				6 Cyl. - 3.0L (181)			
				2000-'00 M14 x 1.5 263-923 N/R			
				1995-'93 M14 x 1.5 263-914 263-817			
				1992-'88 M14 x 1.5 263-974 263-844			
				6 Cyl. - 3.2L (197)			
				2003-'01 M14 x 1.5 263-958 N/R			
				2000-'98 M14 x 1.5 - Inc: Concord 263-923 N/R			
				6 Cyl. - 3.3L (201)			
				2003 M14 x 1.5 263-958 N/R			
				2002-'00 M14 x 1.5 263-923 N/R			
				1999-'90 1/2-20 263-718 N/R			

DRAIN PLUG APPLICATION CHART

APPLICATION DE BOUCHON DE VIDANGE

Make/ Engine/Years	Size	Drain Plug Stock #	Gasket Stock #	Make/ Engine/Years	Size	Drain Plug Stock #	Gasket Stock #
CHRYSLER (continued)				DODGE TRUCK			
6 Cyl. – 3.5L (215)				4 Cyl. 2.0L (122)			
2003-`00	M14 x 1.5	263-958	N/R	1989-`83	M14 x 1.5	263-974	263-844
1999	M14 x 1.5	263-923	N/R	1982-`80	M18 x 1.5	263-928	263-810
1997-`93	1/2-20	263-718	N/R	4 Cyl. 2.2L (135)			
6 Cyl. – 3.7L (225)				1988-`87 1/2 .20 263-710 263-816			
1983-`78	1/2-20	263-710	263-816	4 Cyl. 2.3L (143) - Diesel			
6 Cyl. – 3.8L (230)				1985-`83 M14 x 1.5 263-974 263-844			
2003	M14 x 1.5	263-958	N/R	4 Cyl. 2.4L (143)			
2002-`00	M14 x 1.5	263-923	N/R	1993-`90 M14 x 1.5 263-974 263-844			
1999-`91	1/2-20	263-718	N/R	4 Cyl. 2.5L (153)			
8 Cyl. – All				2004-`94 1/2 .20 263-718 N/R			
1989-`62	1/2-20	263-710	263-816	1993-`89 1/2 .20 263-710 263-816			
DODGE				4 Cyl. 2.6L (156)			
4 Cyl. – 1.4L (1410cc)`84-`82; 1.5L (1468cc); 1.6L (1597cc)`90-`82				1989-`83 M14 x 1.5 263-974 263-844			
1994-`82	M14 x 1.5	263-974	263-844	1982-`80 M18 x 1.5 263-928 263-810			
4 Cyl. – 1.7L (104)				6 Cyl. – 3.0L (181)			
1983-`80	M14 x 1.5 – Magnetic	263-924	263-817	2000-`89 M14 x 1.5 263-974 263-844			
4 Cyl. – 1.8L (1754cc)				6 Cyl. – 3.7L (225)`87-`61; 3.9L (239)			
1994-`89	M14 x 1.5	263-974	263-844	2003-`92 1/2 .20 263-718 N/R			
4 Cyl. – 2.0L (104)				1991-`61 1/2 .20 263-710 263-816			
1983-`80	M14 x 1.5 – Magnetic	263-924	263-817	6 Cyl. – 5.9L (360)			
4 Cyl. – 2.0L (122)				2001-`94 M22 x 1.5 – Diesel 263-940 263-828			
2003-`02	M14 x 1.5	263-958	N/R	1993-`90 M18 x 1.5 – Diesel 263-928 263-810			
2001-`96	M14 x 1.5	263-923	N/R	1989 1/2 .20 – Diesel 263-710 263-816			
1995	1/2-20 – Neon, Status	263-718	N/R	8 Cyl. – 5.2L (318); 5.9L (360)`03-`92			
4 Cyl. – 2.0L (2000cc)				2003-`92 1/2 .20 – Exc: Durango`98-`92 263-718 N/R			
1991-`84	M14 x 1.5 – Colt Vista	263-974	263-844	1991-`62 1/2 .20 263-710 263-816			
4 Cyl. – 2.2L (135)				10 Cyl. – 8.0L (488)			
1994-`81	1/2-20	263-710	263-816	2003-`94 1/2 .20 263-718 N/R			
4 Cyl. – 2.4L (148)				EAGLE			
2003-`01	M14 x 1.5 – Stratus DOHC, Neon, Caravan	263-958	N/R	4 Cyl. – 1.5L (1468cc); 1.6L (1597cc); 1.8L (107); 2.8L (12351cc)			
2003-`01 M14 x 1.5 – Stratus DOHC 263-974 263-844				1996-`89 M14 x 1.5 263-974 263-844			
2000-`96 M14 x 1.5 263-923 N/R				4 Cyl. – 2.0L (121)			
1995 1/2 .20 263-718 N/R				1999-`90 M14 x 1.5 – w/ Turbo`98-`95 263-974 263-844			
4 Cyl. – 2.5L (153)				1999-`95 M14 x 1.5 – w/o Turbo 263-923 N/R			
1995-`86	1/2 .20	263-710	263-816	4 Cyl. – 2.4L (2351cc)			
4 Cyl. 2.6L (156)				1996-`92 M14 x 1.5 263-974 263-844			
1987-`83	M14 x 1.5	263-974	263-844	4 Cyl. – 2.5L (150)			
1986-`78	M18 x 1.5	263-928	263-810	1989-`88 M14 x 1.25 263-922 263-817			
6 Cyl. – 2.5L (152)				6 Cyl. – 3.3L (201); 3.5L (215)			
2004-`95	M14 x 1.5	263-974	263-844	1999-`93 1/2 .20 – Exc: `94-`93, 3.5L 263-718 N/R			
6 Cyl. – 2.7L (167); 3.2L (197)				1994-`93 1/2 .20 – 3.5L 263-710 263-816			
2003-`01	M14 x 1.5	263-958	N/R	FORD			
2000-`96	M14 x 1.5 – Intrepid	263-923	N/R	4 Cyl. – 1.3L (1295cc)			
6 Cyl. – 3.0L (181)				1997-`88 M14 x 1.5 263-934 263-870			
2003-`87	M14 x 1.5 – Exc: `92-`90 Monaco	263-974	263-844	4 Cyl. – 1.6L (1598cc)			
6 Cyl. – 3.3L (201); 3.8L (230)				1980-`78 M14 x 1.5 – Fiesta 263-984 263-876			
2003	M14 x 1.5	263-958	N/R	4 Cyl. – 1.6L (98)			
2002-`00	M14 x 1.5	263-923	N/R	1985-`81 M14 x 1.5 263-937 263-876			
1999-`90	1/2 .20	263-718	N/R	4 Cyl. – 1.8L (110)			
6 Cyl. – 3.5L (215)				1996-`91 M14 x 1.5 263-954 263-856			
2003-`00	M14 x 1.5 – Intrepid	263-958	N/R	4 Cyl. – 1.9L (114)			
1997-`93	1/2 .20 – Intrepid	263-718	N/R	1996 M14 x 1.75 – From 12/12/95 263-908 N/R			
6 Cyl. – All; 8 Cyl. – All				1996-`85 M14 x 1.75 – To 12/11/95 263-937 263-876			
1989-`61	1/2 .20	263-710	263-816				
10 Cyl. 8.0L (488); 8.3L (500)`03							
2003-`92	1/2 .20 – Viper	263-714	263-816				

263
Series



DRAIN PLUG APPLICATION CHART

APPLICATION DE BOUCHON DE VIDANGE

Make/Engine/Years	Size	Drain Plug Stock #	Gasket Stock #	Make/Engine/Years	Size	Drain Plug Stock #	Gasket Stock #
FORD (continued)				FORD TRUCK (continued)			
4 Cyl. - 2.0L (122)				6 Cyl. - 4.0L (245)			
2004-'98	M14 x 1.5 - Escort Multi Port	263-925	NR	2004-'96	M14 x 1.5 - Inc:'00-'96 Explorer	263-925	NR
1997-'95	M14 x 1.5 - Contour	263-914	263-817	2000-'90	M14 x 1.5 - Inc:'00-'96 Aerostar, Ranger	263-937	263-876
1997-'93	M14 x 1.5 - Probe	263-934	263-870	6 Cyl. - 4.2L (256)			
1999-'97	M12 x 1.75 - Escort	263-908	NR	2000-'97	M12 x 1.75	263-908	NR
1987-'84	M14 x 1.5 - Diesel	263-934	263-870	6 Cyl. - 4.9L (300)			
4 Cyl. - 2.2L (2200cc)				8 Cyl. - 4.2L (255)			
1992-'89	M14 x 1.5 - Probe	263-934	263-870	1996-'75	1/2-20	263-710	263-816
4 Cyl. - 2.3L (140); 2.5L (153)				8 Cyl. - 4.6L (281)			
1994-'80	M14 x 1.5	263-937	263-876	1982-'81	1/2-20	263-710	263-816
6 Cyl. - 2.5L (155)				8 Cyl. - 5.0L (302)			
2004-'99	Contour	263-908	NR	2004-'96	M14 x 1.5 - Inc:'96 Explorer	263-914	263-817
1998-'95	M12 x 1.75 - Contour	263-908	NR	1998-'97	M12 x 1.75	263-908	NR
1997-'93	M14 x 1.5 - Probe	263-934	263-870	1996-'80	1/2-20 - Exc:'96 Explorer	263-984	263-876
6 Cyl. - 3.0L (182); 3.2L (195)'95-'93				8 Cyl. - 5.4L (330)'04-'97; 5.8L (351)'98-'80; 6.6L (400)'82-'80			
2004-'97	M14 x 1.5 - Taurus 12 Valve	-	263-876	2004-'88	M14 x 1.5	263-937	263-876
2000-'96	M12 x 1.75 - Taurus 24 Valve	263-922	263-817	1991-'80	1/2-20 - Exc:'89-'88	263-710	263-816
1996-'86	M14 x 1.5 - Exc:'95-'89, Taurus SHO	263-937	263-876	8 Cyl. - 6.9L (421)'87-'83; 7.3L (444)'89-'88			
1995-'89	M14 x 1.5 - Taurus SHO	263-954	263-856	1989-'83	1/2-20 - Diesel	263-714	263-816
6 Cyl. - 3.3L (200)				8 Cyl. - 7.5L (460)			
1983-'74	1/2 .20	263-710	263-816	1997-'85	M14 x 1.5	263-937	263-876
6 Cyl. - 3.8L (232)				8 Cyl. - 7.5L (460)			
2004-'95	M12 x 1.75 - Mustang,'T' Bird	263-908	NR	1985-'80	1/2-20	263-710	263-816
1995-'82	M14 x 1.5 - '95 Taurus	263-937	263-876	GEO			
6 Cyl. - 4.1L (250)				3 Cyl. - 1.0L (993cc); 4 Cyl. - 1.3L (1295cc)'01-'95			
1980-'74	1/2 .20	263-710	263-816	2001-'89	M14 x 1.5 - Metro	263-914	263-817
8 Cyl. - 3.4L (207)				4 Cyl. - 1.5L (1471cc)			
1999-'96	M14 x 1.5 - Taurus SHO	263-954	263-856	1989	M14 x 1.5	263-984	263-876
8 Cyl. - 4.2L (255)				4 Cyl. - 1.6L (1588cc)			
1982-'80	1/2 .20	263-710	263-816	2000-'89	M14 x 1.5 - Tracker	263-934	263-870
8 Cyl. - 4.6L (281)				4 Cyl. - 1.8L (1788cc)			
2003-'92	M14 x 1.5	263-937	263-876	2001-'93	M12 x 1.25 - Prizm	263-942	263-869
8 Cyl. - 5.0L (302)				4 Cyl. - 2.0L (122)			
1995-'90	M14 x 1.5	263-917	263-817	2001-'99	M14 x 1.5 - Tracker	263-914	263-817
1990-'68	1/2 .20	263-710	263-816	HONDA			
8 Cyl. - 5.8L (351)				4 Cyl. - 1.3L (1342cc)'87-'80; 1.5L (1487cc)'95-'79			
1991-'73	1/2 .20	263-710	263-816	1995-'84	M14 x 1.5	263-934	263-870
FORD TRUCK				4 Cyl. - 1.6L (1590cc)			
4 Cyl. - 2.0L (122)				4 Cyl. - 1.7L (1700cc)			
2004-'01	M14 x 1.5 - Escape	263-925	NR	2003-'01	M14 x 1.5 - Civic	263-934	263-870
1989-'83	M14 x 1.5	263-937	263-876	4 Cyl. - 1.8L (1751cc)			
1982-'79	M14 x 1.5	263-934	263-870	1983-'79	M20 x 1.5	263-930	263-851
4 Cyl. - 2.2L (135) - Diesel				4 Cyl. - 1.8L (1829cc)'87-'83; 2.0L (1955cc)'91-'85			
1984-'83	M14 x 1.5	263-934	263-870	1991-'83	M14 x 1.5	263-934	263-870
4 Cyl. - 2.3L (140)				4 Cyl. - 2.0L (1972cc); 2.2L (2156cc); 2.3L (2234cc); 2.3L (2259cc)			
1997-'95	M12 x 1.75	263-908	NR	2004-'90	M14 x 1.5	263-934	263-870
1994-'83	M14 x 1.5	263-937	263-876	4 Cyl. - 2.6L (2559cc)			
1982-'80	M14 x 1.5	263-984	263-876	1996-'94	M14 x 1.5 - Passport Magnetic	263-924	263-817
4 Cyl. - 2.5L (150)				6 Cyl. - 2.7L (2675cc); 3.0L (3000cc); 3.2L (3165cc); 3.5L (3475cc)			
2001-'98	M12 x 1.75	263-908	NR	2004-'94	M14 x 1.5	263-934	263-870
6 Cyl. - 2.8L (171)'86-'83; 2.9L (177)'92-'86							
1992-'83	M14 x 1.5 -	263-937	263-876				
6 Cyl. - 3.0L (182)							
2004-'98	M14 x 1.5 - Ranger	-	263-876				
1998-'86	M14 x 1.5 - Inc:'98 Windstar	263-937	263-876				
6 Cyl. - 3.8L (232)							
2004-'94	M14 x 1.5 - Windstar	263-984	263-876				
1983-'82	M14 x 1.5	263-937	263-876				

DRAIN PLUG APPLICATION CHART

APPLICATION DE BOUCHON DE VIDANGE

Make/ Engine/Years	Size	Drain Plug Stock #	Gasket Stock #	Make/ Engine/Years	Size	Drain Plug Stock #	Gasket Stock #
HUMMER				LINCOLN			
8 Cyl. – All				6 Cyl. – 3.8L (232)			
2000-`92	1/2-20 – Magnetic	263-795	263-875	1994-`82	M14 x 1.5	263-937	263-876
HYUNDAI				8 Cyl. – 4.6L (281)`04-`91; 5.0L (302); 5.0L (302)`92-`78			
4 & 6 Cyl. – All				2004-`90	M14 x 1.5	263-937	263-876
2001-`87	M14 x 1.5	263-974	263-844	1990-`78	1/2-20	263-710	263-816
INFINITI				8 Cyl. – 5.4L (329)			
4, 6 & 8 Cyl. – All				1998	M14 x 1.5 – Navigator	263-937	263-876
2003-`90	M12 x 1.25	263-933	263-885	MAZDA, MAZDA TRUCK			
ISUZU				All Cyl.			
4 Cyl. – All				2003-`71		263-934	263-870
1993-`81	M14 x 1.5	263-934	263-870	MERCEDEZ-BENZ			
ISUZU TRUCK				All Cyl. with 12mm plugs			
4 Cyl. – 1.8L (1877cc); 1.9L (1949cc); 2.2L (2156cc)				1998-`72	M12 x 1.5	263-931	263-869
1997-`81	M14 x 1.5	263-934	263-870	MERCURY			
4 Cyl. – 2.2L (2180cc)				4 Cyl. – 1.6L (1598cc)`89-`87; 1.6L (1600cc)			
2003-`97	M12 x 1.75 – Exc: Amigo Rodeo, Magnetic	263-929	N/R	1994-`91	M14 x 1.5 – Capri, Tracer	263-934	263-870
1996	M12 x 1.75 – Hombre	263-944	263-875	4 Cyl. – 1.6L (98)			
4 Cyl. – 2.2L (2238cc); 2.3L (2234cc); 2.3L (2254cc); 2.6L (2559cc)				1985-`81	M14 x 1.5	263-937	263-876
2004-`86	M14 x 1.5	263-934	263-870	4 Cyl. – 1.8L (110)			
6 Cyl. – 2.8L (2827cc)				1996-`91	M14 x 1.5	263-954	263-856
1991-`89	M14 x 1.5	263-934	263-870	4 Cyl. – 1.9L (113)			
6 Cyl. – 3.1L (3137cc)				1996	M12 x 1.75 – From 12/12/95	263-908	N/R
1994-`91	M12 x 1.75 – Pickup, Rodeo	263-944	263-875	1996-`85	M14 x 1.5 – To 12/11/95	263-937	263-876
6 Cyl. – 3.2L (3165cc); 3.5L (3475cc)				4 Cyl. – 2.0L (122)			
2004-`92	M14 x 1.5	263-954	263-856	2002-`98	M14 x 1.5	263-925	N/R
6 Cyl. – 4.3L (4294cc)				1997-`95	M14 x 1.5 – Mystique	263-914	263-817
2000-`97	M14 x 1.5 – Hombre, Magnetic	263-929	N/R	1997-`97	M12 x 1.75 – Tracer	263-908	N/R
JAGUAR				1987-`84	M14 x 1.5 – Diesel	263-934	263-870
8 Cyl. – 4.0L (3996cc)				4 Cyl. – 2.3L (140)			
1998-`97	M14 x 1.5 – Vanden Plus, XK8, XJ8	263-954	263-856	1994-`80	M14 x 1.5	263-937	263-876
JEEP				6 Cyl. – 2.5L (152)			
4 Cyl. – 2.1L (126)`87-`85; 2.5L (151); 2.5L (150)`02-`83				1998-`95	M12 x 1.75	263-908	N/R
2003-`91	1/2-20	263-718	N/R	6 Cyl. – 3.0L (182)			
1990-`85	M14 x 1.25	263-922	263-817	2004-`97	M14 x 1.5 – Sable, 12 valve	–	263-876
1984-`83	M12 x 1.75 – AMC, Eng.	263-911	263-815	2004-`96	M12 x 1.75 – Sable, 24 valve	263-908	N/R
6 Cyl. – 2.8L (173)				1998-`93	M12 x 1.75 – Villager	263-933	263-885
1986-`84	M14 x 1.25 – Inc: `84 Cherokee	263-922	263-817	1996-`86	M14 x 1.5 – Sable Sable 12 valve, Topaz	263-937	263-876
1985-`84	1/2-20 – Inc: `84 Wagoneer	263-778	263-875	6 Cyl. – 3.3L (3275cc)			
6 Cyl. – 4.0L (242)				2002-`99	M12 x 1.25 – Villager	263-933	263-885
2004-`92	1/2-20	263-718	N/R	6 Cyl. – 3.8L (232)			
1991-`87	M14 x 1.25	263-922	263-817	1997-`95	M12 x 1.75 – Inc: `95 Cougar	263-908	N/R
6 Cyl. – 4.2L (258)				1995-`82	M14 x 1.5 – Inc: `95 Sable	263-937	263-876
1990-`85	M14 x 1.25	263-922	263-817	6 Cyl. – 4.0L (245)			
8 Cyl. – 5.2L (318)				2004-`98	M14 x 1.5 – Mountaineer	263-925	N/R
1998-`93	1/2-20	263-718	N/R	8 Cyl. – 4.6L (281)			
8 Cyl. – 5.9 (360)				1997-`92	M14 x 1.5	263-937	263-876
1998	1/2-20	263-718	N/R	8 Cyl. – 5.0L (302)			
1991-`72	1/2-20 – Magnetic	263-714	263-816	1997	M14 x 1.5 – Mountaineer	263-914	263-817
1991-`72	1/2-20 – Non-Magnetic	263-778	263-875	1995-`90	M14 x 1.5	263-917	263-817
KIA				1990-`68	1/2-20	263-710	263-816
4 Cyl. – 1.6L (1597cc); 1.8L (1839cc); 2.0L (1998cc)				MERKUR			
1998-`93	M14 x 1.5 – Sephia, Sportage	263-934	263-870	All Cyl.			
LEXUS				1989-`85	M14 x 1.5	263-937	263-876
All Cyl.				MITSUBISHI			
2003-`90	M12 x 1.25	263-933	263-885	4 Cyl. up to 1.8L (1834cc) and 2.0L (2000cc)`02			
				2004-`83	M14 x 1.5	263-974	263-844

DRAIN PLUG APPLICATION CHART

APPLICATION DE BOUCHON DE VIDANGE

Make/ Engine/Years	Size	Drain Plug Stock #	Gasket Stock #	Make/ Engine/Years	Size	Drain Plug Stock #	Gasket Stock #
MITSUBISHI (continued)				OLDSMOBILE (continued)			
4 Cyl. – 2.0L (1997cc)				8 Cyl. – 4.0L (242)			
1999-98	1/2-20	263-718	N/R	2000-97	M12 x 1.75 – Aurora Magnetic	263-929	N/R
1997-95	M14 x 1.5 – w/o Turbo	263-923	N/R	1996-95	M12 x 1.75 – Aurora Non-Magnetic	263-919	N/R
1997-84	M14 x 1.5 – Inc: '97-'96 w/ Turbo	263-974	263-844	8 Cyl. – 5.0L (305); 5.0L (307)'90-'81; 5.7L (350)'92-'81 Exc:'91-'86			
4 Cyl. – 2.4L (2351cc)				1992-81 1/2-20 – Exc:'90-'83 263-778 263-875			
2004-85	M14 x 1.5 – Inc: Gallant '04-'98	263-974	263-844	PLYMOUTH			
1999-98	1/2-20 – Eclipse	263-718	N/R	4 Cyl. – 1.5L (1468cc); 1.6L (1597cc)'90-'83; 1.8L (1754cc)'94-'89			
4 Cyl. – 2.6L (2555cc)				1994-83 M14 x 1.5 – Inc: Colt 1.6L 263-974 263-844			
1989-83	M14 x 1.5	263-974	263-844	4 Cyl. – 2.0L (121); 2.4L (148)'00-'96			
6 Cyl. – 3.0L (2972cc); 3.5L (3497cc)				2001-96 M14 x 1.5 263-923 N/R			
2002-88	M14 x 1.5	263-974	263-844	1995	1/2-20	263-718	N/R
MITSUBISHI TRUCK				1994-84	M14 x 1.5	263-974	263-844
4 Cyl., 6 Cyl. – All				4 Cyl. – 2.2L (135)			
2000-83	M14 x 1.5	263-974	263-844	1994-81	1/2-20	263-710	263-816
NISSAN, NISSAN TRUCK				4 Cyl. – 2.4L (2351cc)			
4 Cyl. – 1.6L (1597cc)'01-'87; 1.8L (1809cc)'03-'84; 2.0L (1974cc)'89-'84				1996-81 M14 x 1.5 – Colt, Colt Vista 263-974 263-844			
2003-84	M12 x 1.25	263-913	263-815	4 Cyl. – 2.5L (153)			
1986-82	M16 x 1.33 - 2.0L	263-926	263-809	1995-86	1/2-20	263-710	263-816
4 Cyl. – 2.0L (1998cc)'01-'91; 2.4L (2389cc)'01-87;				4 Cyl. – 2.6L (156)			
2.5L (2500cc)'03-'02				1987-83 M14 x 1.5 263-974 263-844			
2003-87	M12 x 1.25	263-913	263-815	6 Cyl. – 2.5L (152)'98-'95; 3.0L (181)			
6 Cyl. – 3.0L (2960cc); 3.0L (2988cc); 3.3L (3275cc)'02-'96				2004-87 M14 x 1.5 263-974 263-844			
2002-84	M12 x 1.25	263-913	263-815	6 Cyl. – 3.3L (201)			
OLDSMOBILE				2004-00 M14 x 1.5 263-923 N/R			
4 Cyl. – 2.0L (122)				1999-90 1/2-20 263-718 N/R			
1988-87	M12 x 1.75 – VIN 1	263-944	263-875	6 Cyl. – 3.5L (215)			
1988-87	M14 x 1.5 – VIN K	263-778	263-875	2001-00	M14 x 1.5 – Prowler	263-958	N/R
1986-83	1/2-20	263-778	263-875	1999	M14 x 1.5 – Prowler	263-923	N/R
4 Cyl. – 2.2L (134); 2.3L (138)'95-'90				1997 1/2-20 – Prowler 263-718 N/R			
2004-93	M12 x 1.75 – Magnetic	263-929	N/R	6 Cyl. – 3.8L (230)			
1996-93	M12 x 1.75 – Non-Magnetic	263-919	N/R	2004-00	M14 x 1.5	263-923	N/R
1996-93	M12 x 1.75	263-944	263-875	1999-94	1/2-20	263-718	N/R
4 Cyl. – 2.4L (146)				8 Cyl. – All			
2002-97	M12 x 1.75 – Magnetic	263-929	N/R	1989-64	1/2-20	263-710	263-816
1996	M12 x 1.75 – Non-Magnetic	263-919	N/R	PONTIAC			
4 Cyl. – 2.5L (151)				4 Cyl. – 1.6L (98)'93-'81; 2.0L (122)			
1987-79	M12 x 1.75	263-944	263-875	1994-87	M14 x 1.5	263-934	263-870
6 Cyl. – 2.8L (173)				1986-83 1/2-20 263-778 263-875			
1989-83	M12 x 1.75	263-944	263-875	4 Cyl. – 1.8L (1762cc)			
1986-80	1/2-20	263-778	263-875	2004-03	M12 x 1.25 – Vibe	263-942	263-869
6 Cyl. – 3.0L (181)				4 Cyl. – 2.2L (134)			
1988-83	1/2-20	263-778	263-875	2004-97	M12 x 1.75 – Magnetic	263-929	N/R
1982	M12 x 1.75	263-944	263-875	1996-95	M12 x 1.75 – Non-Magnetic	263-919	N/R
6 Cyl. – 3.1L (189)				1995 M12 x 1.75 263-944 263-875			
1999-97	M12 x 1.75 – Magnetic	263-929	N/R	4 Cyl. – 2.3L (138)			
1996-94	M12 x 1.75 – Non-Magnetic	263-919	N/R	1995-90	M12 x 1.75	263-919	N/R
1994-89	M12 x 1.75	263-944	263-875	4 Cyl. – 2.4L (146)			
6 Cyl. – 3.3L (204)				2003-97 M12 x 1.75 – Magnetic 263-929 N/R			
1993-89	1/2-20	263-778	263-875	1996	M12 x 1.75 – Non-Magnetic	263-919	N/R
6 Cyl. – 3.4L (207); 3.5L (214)'02-'99				4 Cyl. – 2.5L (151)			
2004-97	M12 x 1.75 – Magnetic	263-929	N/R	1987-79	M12 x 1.75	263-944	263-875
1996-94	M12 x 1.75 – Non-Magnetic	263-919	N/R	6 Cyl. – 2.8L (173)			
1993-91	M12 x 1.75	263-944	263-875	1989-87	M12 x 1.75	263-944	263-875
6 Cyl. – 3.8L (231)'99-'77; 4.2L (256)'04-'02; 4.3L (262)'04-'91				1986-79 1/2-20 263-778 263-875			
2004-97	M12 x 1.75 – Magnetic	263-929	N/R	6 Cyl. – 3.0L (181)			
Inc: Bravada				1987-85 1/2-20 263-778 263-875			
1996	M12 x 1.75 – Inc: Bravada	263-919	N/R				
1994-77	1/2-20 – Inc: Bravada	263-778	263-875				

DRAIN PLUG APPLICATION CHART

APPLICATION DE BOUCHON DE VIDANGE

Make/ Engine/Years	Size	Drain Plug Stock #	Gasket Stock #	Make/ Engine/Years	Size	Drain Plug Stock #	Gasket Stock #
PONTIAC (continued)				TOYOTA (continued)			
6 Cyl. - 3.1L (189)				4 Cyl. - 2.2L (2164cc); 2.4L (2398cc) '03-'02			
2004-'97	M12 x 1.75 - Magnetic	263-929	N/R	2003-'92	M12 x 1.25 - 5SFE, 2AZFE	263-942	263-869
1996-'94	M12 x 1.75 - Non-Magnetic	263-919	N/R	1991-'90	M12 x 1.25 - 5SFE	263-913	263-815
1994-'88	M12 x 1.75	263-944	263-875	6 Cyl. - 2.5L (2508cc)			
6 Cyl. - 3.3L (204)				1991-'88 M12 x 1.25 - 2VZFE 263-942 263-869			
1993-'92	1/2-20	263-778	263-875	6 Cyl. - 3.0L (2954cc)			
6 Cyl. - 3.4L (207)				1992-'87 M18 x 1.5 - 7MGE, 7MGTE 263-928 263-810			
2004-'97	M12 x 1.75 - Magnetic	263-929	N/R	6 Cyl. - 3.0L (2959cc)			
1996-'95	M12 x 1.75 - Exc: Firebird Non-Magnetic	263-919	N/R	1993-'92 M12 x 1.25 - 3VZFE Camry 263-942 263-869			
1995-'91	M12 x 1.75 - Inc: '95 Firebird	263-944	263-875	6 Cyl. - 3.0L (2995cc)			
6 Cyl. - 3.8L (2319); 4.3L (262) '87-'86				2004-'94 M12 x 1.25 - 1MZFE 263-942 263-869			
2004-'97	M12 x 1.75 - Magnetic	263-929	N/R	6 Cyl. - 3.0L (2997cc)			
1996-'95	M12 x 1.75 - Non-Magnetic	263-919	N/R	1998-'93 M12 x 1.25 - 2JZGE, 2JZGTE 263-942 263-869			
1994-'77	1/2-20	263-778	263-875	TOYOTA TRUCK			
8 Cyl. - 5.0L (305) '92-'76; 5.0L (307) '90-'81; 5.7L (350) '02-'67				6 Cyl. - 2.0L (1998cc)			
2002-'97	M12 x 1.75 - Magnetic	263-929	N/R	2004-'96 M12 x 1.25 - 3SFE 263-942 263-869			
1996	M12 x 1.75 - Non-Magnetic	263-919	N/R	1995-'92 M12 x 1.25 - 22R, RE REC, RTEC from 03/92 263-942 263-869			
1995-'67	1/2-20	263-778	263-875	4 Cyl. - 2.0L (1988cc)			
SAAB				1989-'88 M12 x 1.25 - 22R, RE REC, RTEC to 03/92 263-913 263-815			
4 & 6 Cyl.				4 Cyl. - 2.4L (2398cc) '03-'01; 2.4L (2438cc); 2.7L (26944cc)			
2004-'80	M14 x 1.5	263-914	263-817	2003-'94 M12 x 1.25 - 2RZFE, 3RZFE 2AZFE 263-942 263-869			
SATURN				6 Cyl. - 3.0L (2959cc); 3.0L (2995cc)			
2002-'91	M12 x 1.75	263-932	N/R	2003-'01 M12 x 1.25 - 1MZFE 263-942 263-869			
SUBARU				1995-'88 M12 x 1.25 - 3VZE 263-942 263-869			
3, 4 & 6 Cyl. w/ 20mm plug				6 Cyl. - 3.4L (3378cc)			
2003-'73	M20 x 1.5	263-930	263-851	2003-'95 M12 x 1.25 - 5VZFE 263-942 263-869			
SUZUKI				6 Cyl. - 4.0L (3956cc); 4.0L (4000cc) '03			
All 4 & 6 Cyl. w/ 14mm plug				2003 M12 x 1.25 - 1GRFE 263-942 263-869			
2003-'86	M14 x 1.5	263-914	263-817	1992-'88 M12 x 1.25 - 3FE 263-942 263-869			
TOYOTA				6 Cyl. - 4.2L (4227cc)			
4 Cyl. - 1.5L (1456cc)				1987-'86 M12 x 1.25 - 2F 263-942 263-869			
1994-'87	M12 x 1.25 - 3E, 3EE	263-942	263-869	1987-'82 M18 x 1.5 - 2F 263-928 263-810			
4 Cyl. - 1.5L (1497cc)				6 Cyl. - 4.5L (4477cc)			
2003-'92	M12 x 1.25 - 5EFE	263-942	263-869	2004-'98 M12 x 1.25 - 1FZFE 263-942 263-869			
4 Cyl. - 1.6L (1587cc)				8 Cyl. - 4.7L (4663cc)			
1997-'89	M12 x 1.25 - 4AFE, 4AGE from 12/88	263-942	263-869	1992-'91 M12 x 1.25 - 2UZFE 263-942 263-869			
1989-'88	M12 x 1.25 - 4AF to 12/88	263-933	263-885	VOLKSWAGEN			
1989	M12 x 1.25 - 4AGZE from 12/88	263-942	263-869	4 Cyl. - 1.6L (1588cc); 1.7L (1715cc); 1.8L (1780cc); 1.8L (1800cc); 1.9L (1896cc); 2.0L (1984cc)			
1989-'88	M12 x 1.25 - 4AGZE to 12/88	263-933	263-885	1998-'74 M14 x 1.5 263-917 263-817			
1989-'85	M12 x 1.25 - 4AGEC, 4AGELC to 12/88	263-933	263-885	6 Cyl. - 2.8L (2792cc)			
1989	M12 x 1.25 - 4AGEC, 4AGELC from 12/88	263-942	263-869	1998-'92 M14 x 1.5 263-917 263-817			
1988-'85	M12 x 1.25 - 4AFE, 4AF, 4ALC, 4AC	263-933	263-885	VOLVO			
1984-'83	M18 x 1.5 - 4AC, 4ALC	263-928	263-810	4 Cyl. - 2.3L (2316cc)			
4 Cyl. - 1.8L (1762cc)				1995-'83 3/4-16 263-750 263-824			
2003-'93	M12 x 1.25 - 1ZZFE, 2ZZGE, 7AFE	263-942	263-869	5 Cyl. - 2.3L (2319cc)			
4 Cyl. - 2.0L (1988cc)				1998 3/4-16 263-750 263-824			
1995-'90	M12 x 1.25 - 3SGTE, 3SFE from 12/89	263-912	263-815	5 Cyl. - 2.4L (2319cc)			
1990-'88	M12 x 1.25 - 3SGTE, 3SFE to 12/89	263-913	263-815	1997-'93 M18 x 1.5 - 850 263-928 263-810			
1989-'88	M12 x 1.25 - 3SGELC	263-913	263-815	5 Cyl. - 2.4L (2435cc)			
4 Cyl. - 2.0L (1988cc)				1998 3/4-16 - C70, S70, V70 263-750 263-824			
1988-'84	M18 x 1.5 - 3SGELC 3SGTE, 3SFE, 3YEC	263-928	263-810	6 Cyl. - 2.8L (2849cc)			
				1990-'83 3/4-16 263-750 263-824			
				6 Cyl. - 2.9L (2917cc)			
				1998-'92 3/4-16 263-750 263-824			

263 Series



'DUO-DRAIN®' OIL PLUG BOUCHON D'HUILE DUO-DRAIN®

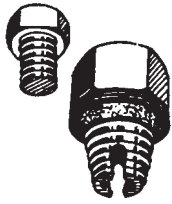

BRIGHT PLATED

All metal, two-part plug for repairing 1/2"-20 crankcase applications on GM, Ford, Chrysler and AMC. STANDARD or Self-tapping DOUBLE OVERSIZE outer plug installs permanently. Only the pipe threaded centre plug is removed to drain oil. Convenient skin-packed card contains one (1) Duo-Drain Oil Plug complete with gasket.

1/2-20 D.O. No. 263-799



CARDED DRAIN PLUGS with GASKET BOUCHON DE VIDANGE avec JOINT

Convenient skin-packed card contains one 'Papco' Drain Plug complete with gasket. Order by Card Number.

1/2-20 S.O. No. 263-791

Card No.	Size & Type
263-777	M14 x 1.5 Pilot Pt.
263-780	M12 x 1.75 Std. Pilot Pt.
263-781	M12 x 1.75 Std. Magnetic
263-782	1/2-20 T.O. Self-Tap
263-783	1/2-20 Magnetic
263-784	M14 x 1.5 Magnetic

Card No.	Size & Type
263-786	M14 x 1.5 Pilot Pt.
263-787	M12 x 1.75 Pilot Pt.
263-788	M12 x 1.75 Pilot Pt.
263-790	1/2-20 Std.
263-791	1/2-20 S.O. Self-Tap
263-792	1/2-20 D.O. Self-Tap

Card No.	Size & Type
263-793	1/2-20 T.O. Self-Tap
263-794	1/2-20 Magnetic
263-796	M14 x 1.5 Pilot Pt.
263-797	M12 x 1.75 Magnetic
263-798	M14 x 1.5
263-799	1/2-20 Duo



MAGNETIC DRAIN PLUG with GASKET

'Papco' Magnetic Drain Plugs reduce wear and protect engines by attracting harmful metal particles circulating in the crankcase oil. Powerful, long-lasting ALNICO magnet. Install in place of ordinary plugs. Individually skin-packed with gasket.

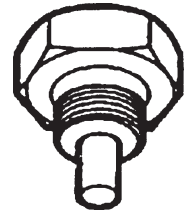

Card No.	Size & Thread	Gasket No.
263-781	12mm x 1.75 Magnetic	263-815
263-784	14mm x 1.5 Magnetic	263-815

Card No.	Size & Thread	Gasket No.
263-794	1/2-20 Std. Magnetic	263-824

Card No.	Size & Thread	Gasket No.
263-794	1/2-20 Std. Magnetic	263-824

GARAGE ASSORTMENT No. 020-054

Contains 60 Nylon Gaskets in six popular sizes for Inch and Metric Drain Plugs.



GARAGE ASSORTMENT No. 020-032

Contains 7 Self-Tapping Oversize Drain Plugs with gaskets. (4) 1/2-20 O.S.; (2) 1/2-20 D.O. ; (1) 1/2-20 T.O.

GARAGE ASSORTMENT No. 020-038

Contains 9 Inch and Metric Drain Plugs with gaskets. (4) 1/2-20 Std. (3) 12mm x 1.75, (2) 14mm x 1.5.



MASTER DRAIN PLUG ASSORTMENT No. 020-630

Contains 40 Inch and Metric Plugs; 73 Gaskets - and includes:

- Magnetic and 1/2-20 oversize plugs.
- 17 Sizes of Plugs, 8 Sizes of Gaskets.
- Complete coverage for most vehicles.

MASTER DRAIN PLUG GASKET ASSORTMENT No. 020-607

Contains 210 pieces - 20 of the most popular Sizes of Nylon, Copper, Fibre, Aluminum and Rubber/Metal Drain Plug Gaskets.

020-630



OIL DRAIN PLUGS BOUCHONS DE VIDANGE



'Papco' CARDED OIL DRAIN PLUG MERCHANDISER No. 022-130

Contains all 18 sizes of carded 'Papco' Oil Drain Plugs with gaskets – 26 plugs in total. Includes header sign and merchandising rack suitable for wall, pegboard, counter or gondola display.

'Papco' Carded Drain Plugs may be ordered individually or in Shelf-Paks of 5.

Card No.	Plug No.	Size & Type	020-130 Contents	Card No.	Plug No.	Size & Type	020-130 Contents
263-777	263-937	M14 x 1.5 Pilot Pt.	1	263-790*	263-710	1/2-20 Std.	2
263-780*	263-911	M12 x 1.75 Std. Pilot Pt.	1	263-791	263-711	1/2-20 S.O. Self-Tap	1
263-781	-	M12 x 1.75 Std. Magnetic	1	263-792	263-712	1/2-20 D.O. Self-Tap	1
263-782	263-913	M12 x 1.25 Std.	1	263-793	263-713	1/2-20 T.O. Self-Tap	1
263-783*	263-914	M14 x 1.5 Std.	2	263-794	263-714	1/2-20 Magnetic	1
263-784	263-924	M14 x 1.5 Magnetic	1	263-796	263-925	M14 x 1.5 Pilot Pt.	1
263-786	263-923	M14 x 1.5 Pilot Pt.	2	263-797*	263-929	M12 x 1.75 Magnetic	3
263-787	263-908	M12 x 1.75 Pilot Pt.	1	263-798	263-958	M14 x 1.5	1
263-788*	263-919	M12 x 1.75 Pilot Pt.	4	263-799	-	1/2-20 Duo	1

*Bonus cards to offset cost of rack.